VIRUSKILLER

World Leading Air Sterilization and
Purification Equipment
VK-002/102

USER GUIDE & INSTRUCTIONS



RADIC8

RADIC8

Sales & Design: Radic8 Ltd

Man & Scythe Building 6 - 8 Churchgate Bolton, BL1 1HL, UK
Tel : +44 (0)1204 238823, E-mail: info@radic8.com, www.radic8.com

Manufacturer: INBair Co., Ltd

3F, 15, Beotkkot-ro 12-gil, Geumcheon-gu, Seoul, Korea
Tel: +82-31-811-1000, E-mail: inbair01@naver.com, www.inbair.com

Made in Korea, Designed in England

Table of Contents

Safety Instructions.....	1
Operation Instructions.....	4
Key Parts and Components.....	5
VirusKiller Functions.....	8
Cleaning and Maintenance.....	14
Error Messages.....	18
Troubleshooting.....	20
Customer Service.....	21
Specifications.....	22
Limited Warranty Card	

Important Safety Instructions

The following instructions are provided to ensure your safety and to protect the unit from accidental damage.

- **Read these instructions** – All the safety and operating instructions should be read before this product is operated.
- **Keep these instructions** – The safety and operating instructions should be retained for future reference.
- **Heed all warnings** – All warnings on the appliance and in the operating instructions should be adhered to.
- **Follow all instructions** – All instructions for use and operation should be followed.



Warranty – included inside

Warning – This symbol indicates important safety instructions that must be followed to avoid injury.

Caution – This symbol is to bring important information to your attention to avoid the risk of injury or damage to the unit.



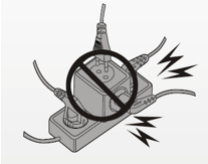

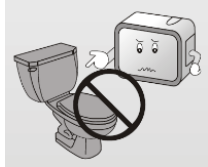
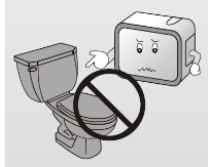

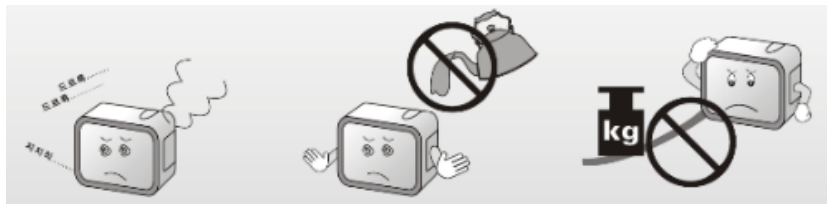

Prohibited – This symbol indicates a forbidden action. Adhere to these to reduce the risk of injury or damage to the unit.

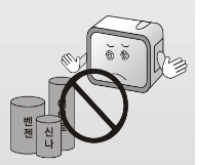
Electrical Safety

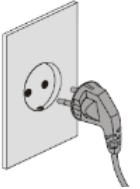
- The unit should only be connected to a properly grounded mains power supply with voltage that matches that specified.
- To prevent overload, do not share the same power supply socket with too many other electronic components. 
- Do not place the power cord where it could be stepped on or tripped over. 
- Do not place heavy items on the power cord, they could damage the wire. 
- Do not allow water or moisture to enter the unit or power adapter. 
- Do not use in wet, moist areas such as bathrooms, steamy kitchens or near swimming pools.
- Pull the plug out immediately and seek professional help if the plug or power cord is damaged, liquid is spilled onto the unit, if it is accidentally exposed to moisture or the unit is not working normally.

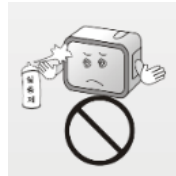

Operation Safety

- Keep the product away from flammable gases and liquids, candles and open flames. 
- Do not install near any heat sources such as radiators, stoves, or other apparatus that produce heat.
- Do not attempt to repair or replace any part of this equipment unless it is specifically recommended in the user guide. All other services should be referred to a qualified technician. 
- Make sure the power cord is plugged firmly and completely into the outlet.
- Hold the main plug, not the wires, when removing from a socket. 
- During a thunderstorm switch off the unit and unplug from the socket.
- Do not handle the unit with wet hands. 
- Only clean with a soft, dry cloth. Do not use solvents or petroleum based fluids. 
- Do not place heavy objects on the unit. 
- Do not shake, knock or move the product while in operation, you may damage the internal circuits. 
- If a strange smell, noise, or smoke is emitted, turn off immediately and contact customer services.**  

Operation Instructions

- **Switch off while cleaning the room**

After cleaning, it is important to properly ventilate the room before using VirusKiller again.



- **Switch off while cooking**

Oils released while cooking may reduce the lifespan of the sterilizing module. After cooking, the room should be ventilated to remove oils. VirusKiller can then be used to remove the remaining smell.



- **Ensure airflow is not restricted**

Do not position VirusKiller so that airflow to and from the unit is restricted by large items such as furniture, electronic items or curtains.

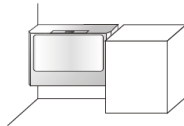

- **Position at least 3 metres from the bed**

To avoid excessive cooling caused from sleeping in direct airflow, we recommend positioning VirusKiller at least 3 metres away from the bed.



- **Maintain proper ventilation – 30 minutes per day**

VirusKiller is designed to purify and sterilize your indoor air, and will do this very effectively if used correctly. Good indoor air quality also requires proper ventilation. We recommend opening windows or doors, or operating A/C units, for at least 30 minutes a day.

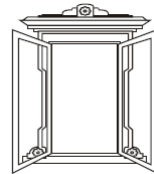

- **Maintain regular servicing and maintenance**

⚠ Caution

- The appliance is not to be used by children or persons with reduced physical, sensory or mental capabilities. This appliance is not a toy. Children should be supervised at all times.
- **Never look directly at a burning ultra-violet light – this may permanently damage your eyes. Switch off and unplug before performing maintenance.**

Key Parts and Components



VK-102



VK-002

VK-102 Internal Structure



VIRUSKILLER®

- DISPLAY AND MONITORING**
 - 4 Way Wind Direction
 - 16ea LED Display
- SILENCER**
 - Noise Cancelling Silencer For Whisper Quiet Operation
- REACTOR CELL (STERILIZING MODULE)**
 - 8 - 16 Super UVC Lamps
 - Mirrored Coating For Ultimate Reflection
 - 72 - 135 TiO₂ nano Tube filters for generator -OH Radical (world's strongest oxidant)
 - Loose Activated Carbon Inside Tube Filters Absorbs Odours And Pollutants Allowing PCO to Decompose
- VENTILATION**
 - Double Inlet Sirocco Fan
 - S. pressure 78mmAq 16m³/min
- COMPLEX FILTERS**
 - HEPA filter 50mm coated nano silver
 - Medium filter 25mm coated nano silver (option)
 - Carbon Filter 20mm
 - Pre filter 5mm

Control Panel and Display

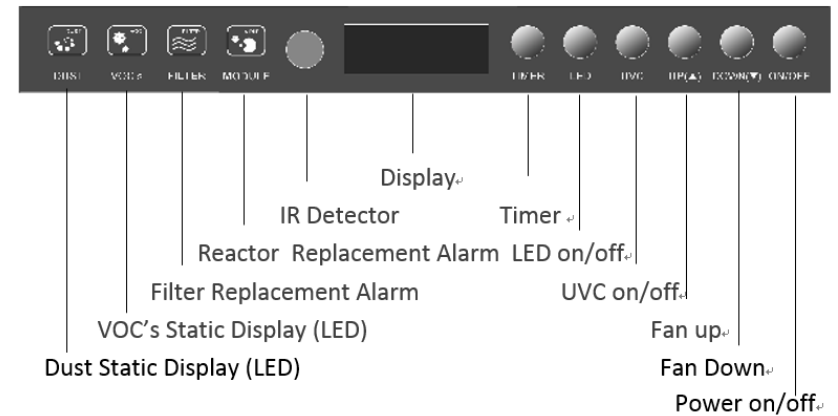

LED Indicators

DUST and VOC's LED, color indicates air quality: blue – good, yellow – normal, red – poor
 FILTER LED, color indicates status: blue – OK, red – due for replacement
 MODULE LED, color indicates status: blue – OK, red – Reactor due for replacement

Remote Controller

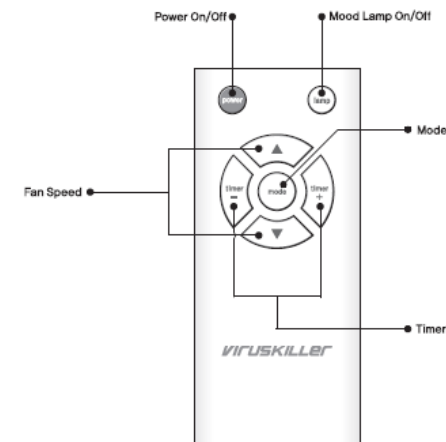

VirusKiller Functions

Automatic Operation Mode

When the unit is switched on, either by the power switch on the main control board or the on/off button on the remote control, the product is in automatic mode. Blue LED lights are displayed and the fan is set to quiet mode (FAN 1). If small amounts of dust or VOC's are detected by the sensor, the LED color changes to yellow. If high levels of dust or VOC's are detected, the LED changes to red and the fan speed switches to full power (FAN 3). When the dust or VOC levels return to healthy levels, the unit automatically returns to quiet mode and displays the blue LED.

- Blue LED – Air quality is GOOD
- Yellow LED – Air quality is NORMAL
- Red LED – Air quality is POOR

Note – When the unit is switched on the Indoor Air Quality sensor (IAQ) takes 2 minutes to calibrate.

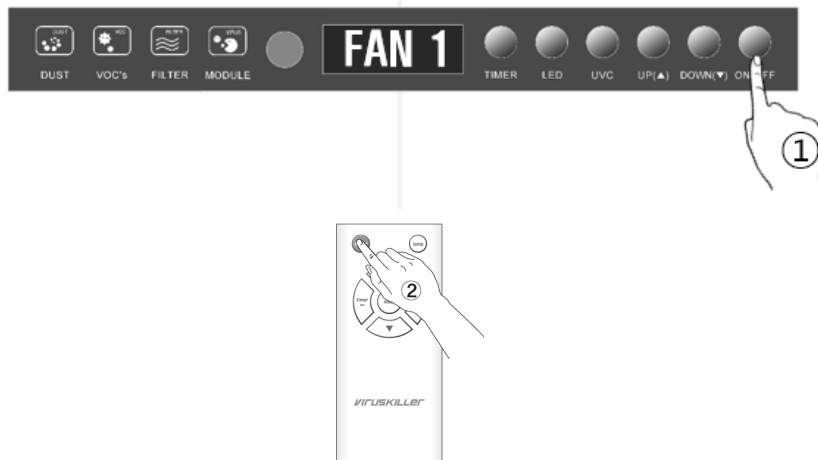

When power button is pressed, the product emits a beep sound and begins to operate. If the product does not operate, ensure the socket is plugged securely into a live, properly grounded outlet of the correct voltage.

Manual Operation Mode

If you wish to stop automatic mode and manually operate the unit, press any button on the main board or on the remote control. You may then operate the unit as shown below.

Increasing the Fan Speed

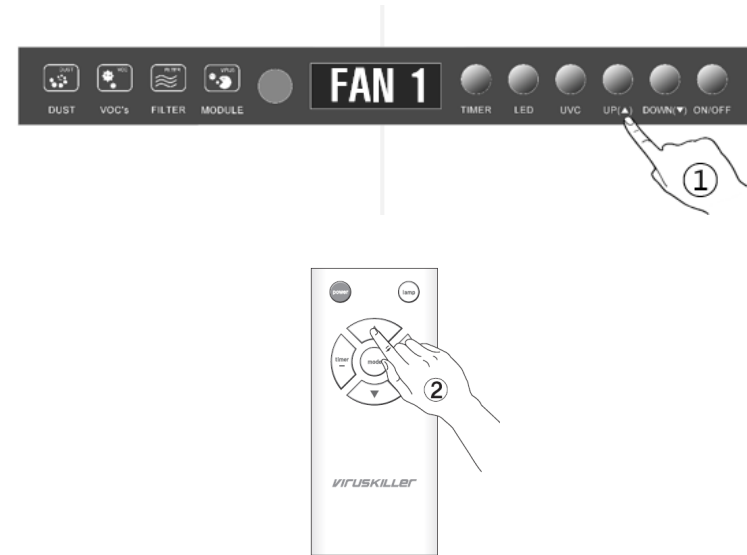

Press up button on main board ① or

Press ▲ button of remote controller ②

Fan speed will increase when the UP button is pressed and the unit will beep.

FAN 1 Quiet Mode

FAN 2 Normal Mode

FAN 3 High Speed Mode

Reducing the Fan Speed



Press down button on main board ① or
 Press ▼ button of remote controller ②
 Fan speed will decrease when the DOWN button is pressed and
 the unit will beep.

- FAN 1** Quiet Mode
- FAN 2** Normal Mode
- FAN 3** High Speed Mode

Operating the UVC Lamp



Press UVC button on main board ①
 Pressing the UVC button switches the UVC Lamp off; the unit will beep and the UVC
 button will not be lit. Pressing the UVC button once more switches on the UVC Lamp.

Operating the LED Mood Lamp



Press LED button on main board ① or
 Press LAMP button on remote controller ②



Setting the Timer

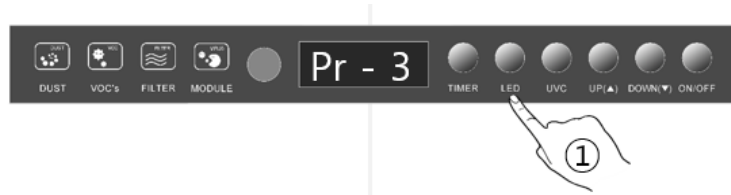

Press TIMER button on main board ① or TIMER on remote controller ②

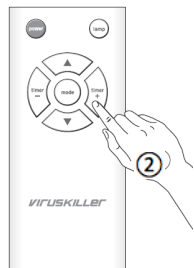

Repeatedly pressing TIMER will toggle through the preset options. The unit will automatically switch off when the programmed time has passed.

- Pr - 3** 3 hours preset
- Pr - 6** 6 hours preset
- Pr - 9** 9 hours preset

Mode Indicator



Repeatedly pressing the MODE button on the remote controller ② changes the display in the following order:

- 0001** Operation time (in hours) of Sterilizing Module
- _27d** Current temperature
- FAN3** Fan Speed

Switching the Unit Off



Press Power off switch on main board ① or

Press Power off switch on remote controller ②

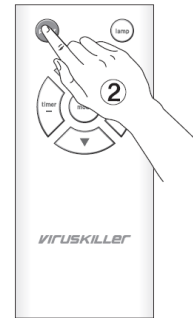

To switch the unit off, press the POWER button on the unit or on the remote control.

Turn the product off and unplug power cord when not in use for an extended period of time.

Cleaning and Maintenance

Cleaning the Pre-Filter

The plastic pre-filter is reusable. To clean it follow this procedure:

1. Pull out the filter case ①.
2. Remove pre-filter case ② from filter case ① and separate from carbon filter ③ and HEPA filter ④.
3. Clean the pre-filter with plain water.
4. Allow to dry completely out of direct sunlight.
5. Replace



Ensure you have removed the HEPA and carbon filters before washing the pre-filter

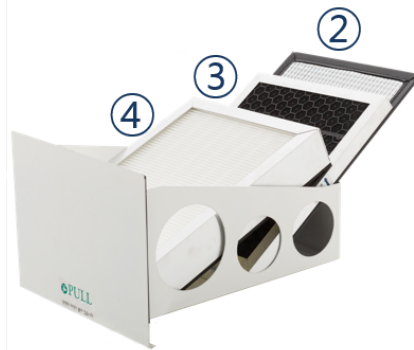

We recommend you check the pre-filter regularly and clean it as often as necessary, depending on the levels of pollution.

Replacing the Carbon Filter and HEPA Filter



Every 2000 hours the FILTER LED ① changes color from blue to red, indicating it is time to replace the HEPA and carbon filters. After replacing the filters (as shown above) press and hold the UP switch ② for at least 5 seconds to reset the FILTER timer to zero.

The HEPA and carbon filters are not reusable and should be replaced.

Depending on the levels of pollution the lifetime of the HEPA and carbon filters may be longer or shorter than the recommended 2000 hours use time.

Please contact your local customer service center or distributor to purchase replacement HEPA and carbon filters.

Replacing the Reactor Cell



Every 8000 hours the MODULE LED ① changes color from blue to red and the display shows a minus figure ②, indicating it is time to replace the Reactor Cell (also called the Sterilizing Module).

⚠ CAUTION

The Reactor Cell is not reusable and should be replaced. The Reactor Cell is a complex and high voltage piece of equipment. Users are not permitted to attempt repair or replacement. All work is to be carried out by a qualified technician.

Please contact your local customer service center or distributor to arrange for the Reactor Cell to be replaced.



REACTOR CELL VK-102 VK-002

Cleaning the Indoor Air Quality (IAQ) Sensor

The IAQ sensor is a very delicate instrument that uses light scattering to detect pollution. It therefore needs a clean lens to work effectively. Regular maintenance (every 6 months) should be carried out to keep the lens clean.

Important - Only use pure water and allow to dry completely before replacing. To avoid damage to the plastic lens do not use chemicals such as benzene or alcohol etc.

Procedure to maintain and clean the IAQ Sensor:

1. Locate the IAQ sensor on the side of the unit
2. Clean lens with a clean cotton swab dampened with pure water as shown below.
3. Allow lens to dry completely.

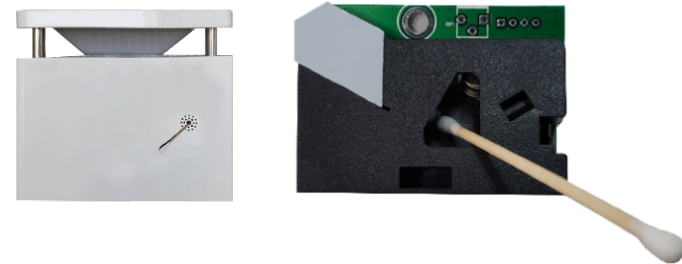

⚠ **CAUTION**
Do not spray water or perfume near the sensor.

Error Messages

Reactor Cell Replacement Due



When the display shows a minus figure the Reactor Cell (Sterilizing Module) is due for replacement. It is important to arrange this when prompted to avoid any reduction in the sterilizing power and lifespan of the unit.

Switch off the unit and contact the customer service center.

Circuit Overheat Error

The below error message is displayed when the circuit is overheated.

Switch off the unit and contact the customer service center.



When to Replace the Carbon and HEPA Filter

When the FILTER LED ① changes from blue to red, it is time to replace the HEPA and carbon filters. After replacing the filters, press and hold the UP switch ② for at least 5 seconds to reset the HEPA timer to zero.



Please contact your local customer service center or distributor to purchase replacement HEPA and carbon filters.

Poor Air Quality Indicator

When fine dust and VOC's are detected at unhealthy levels by the IAQ sensor, the DUST ① and VOC's ② LED lights will change from red to blue. VirusKiller should be set to FAN 3 and the room ventilated to improve the air quality. The LED lights will change to blue when the air quality has returned to healthy levels.

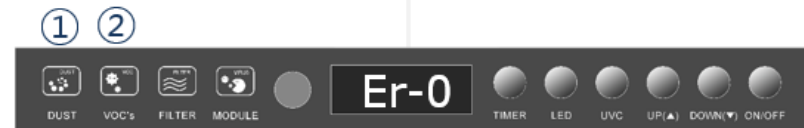

Troubleshooting

Before you call for service, review this list. It may save you time and expense. This list includes common occurrences that are not the result of defect in workmanship or materials.

Problem – Product will not turn on.

- Q. Is power cord correctly connected to outlet?
- A. Put power plug into AC outlet and DC jack again.

- Q. Check remote controller?
- A. Change / reinstall batteries correctly according to the polarity.

- Q. Check the outlet?
- A. This product should be plugged into a properly grounded outlet with the correct voltage (as shown on the back of the unit).

Problem – The air purifying function is not effective.

- Q. Is the air in the room seriously contaminated?
- A. Use only after sufficient ventilation, minimum 30 minutes.

- Q. Check if the pre-filter is heavily contaminated.
- A. Clean the pre-filter

- Q. Check if the HEPA filter is heavily contaminated.
- A. Replace HEPA filter.

- Q. Check the room size compared to the product specifications.
- A. Select the appropriate model of VirusKiller to suit the space to be covered.

- Q. Check if airflow is restricted?
- A. Make sure there is sufficient clearance around the product and that the air inlet and outlet are not blocked by furniture, curtains, etc.

Problem – The unit is emitting a strange smell

- Q. Is this a 'new product' smell?
- A. It may be an antimicrobial smell emitted by the sterilizing module or filters and will disappear over a short period of operation (1-2 weeks). It is completely harmless to humans and animals.

- Q. Is the washable pre-filter completely dry?
- A. This may be from the pre-filter if replaced before dry. Remove, wash again, and allow to dry completely before further operation.

- Q. Has the unit been used during or shortly after cooking?
- A. Some food odors can permeate into the filter or sterilizing module. Only switch on the unit after sufficient ventilation.

- Q. Has the unit been used where there are heavy emissions of smoke or odors?
- A. In areas emitting smoke or odors, the performance of the sterilizing module may be affected. Use after ventilation.

Problem – Weak wind volume or unusual noise from the product.

- Q. Check if dust has accumulated in the filter?
- A. Filters should be replaced or cleaned at appropriate time.

Customer Services

In this manual, you will find a card containing details of your limited warranty and contact details for your local customer services center, to whom all enquiries and warranty claims should be directed.

All warranties are rendered void and the cost of repair will be payable by the user in the case of:

1. Damages caused by putting foreign objects (such as water, soft drink, coffee, fragrance oils or toy etc.) in or on the unit.
2. Damages caused by transportation or handling.
3. Damages caused by use of products such as benzene or thinner.
4. Damages caused by using incorrect power supply or output voltage.
5. Breakdown or loss of parts caused by unauthorized disassembling or modification.
6. Repair or replacement undertaken by unauthorized persons.
7. Damages caused by non-adherence to the instructions provided in this user guide, and as given by the local customer service center.
8. Damages caused by careless or improper use.
9. Damages caused by operating the product in a corrosive or moist environment.

VIRUSKILLER

Specifications



VK-102

VK-002

The company reserves the right to make changes to the exterior, design or specifications of the product without prior notice.

Description	Air Purifier	Air Purifier
Brand	VIRUSKILLER	VIRUSKILLER
Model No	VK-102	VK-002
Elec. Power	Check back of unit	Check back of unit
Elec. Consumption	350 watt	280 watt
Net Weight	40 Kg	29 Kg
Gross Weight	44 Kg	33 Kg
Net Dimension	1570 x 320 x 320mm	1220 x 320 x 320 mm
Box Dimension	1680 x 460 x 440 mm	1340 x 460 x 440 mm

--	--

